



ART'S WAY MANUFACTURING CO., INC.

www.artsway-mfg.com

SERVICE BULLETIN

Bale Processor Key

DATE: 04/30/2020

BULLETIN NO: 20-001

TITLE: Top Spread Drive Sprocket Key

RATING: Incorrect Part Used

PRODUCT SERIES / MODEL: 864 & 664 Top Spread Bale Processors

SERIAL NO: N/A

SUMMARY: A 3/8 Key used on the drive sprocket was too short when installed

OPERATIONAL IMPACT: Not enough key engagement can produce excessive wear in a short time, potentially damaging other components.

ACTION: Remove 3/8 x 1-1/4" key and replace with 3/8 x 2" Key

CONTACT: If you have any questions or if we can be of any service, please contact the Art's-Way Manufacturing Co., 712-864-3131 (Service/Technical Support)

Purpose:

This bulletin is to inform the owners of any Art's Way Bale Processors that an incorrect length key may have been used while attaching the drive sprocket to the lower rotor.

The incorrect hardware can cause additional wear to the shaft and keyway, potentially damaging the unit. Art's Way recommends that 864 and 664 Top Spreads be inspected and corrected as soon as possible.

Please follow this service bulletin immediately as to avoid critical rotor failure.

Instructions:

Open the side door, remove the hardware and chain around sprocket 650129. Inspect the Key. If the Key is shorter than 2", replace it with part number 021530 (Key, Square 3/8 x 2). Reassemble components, aligning sprockets and tightening chains.

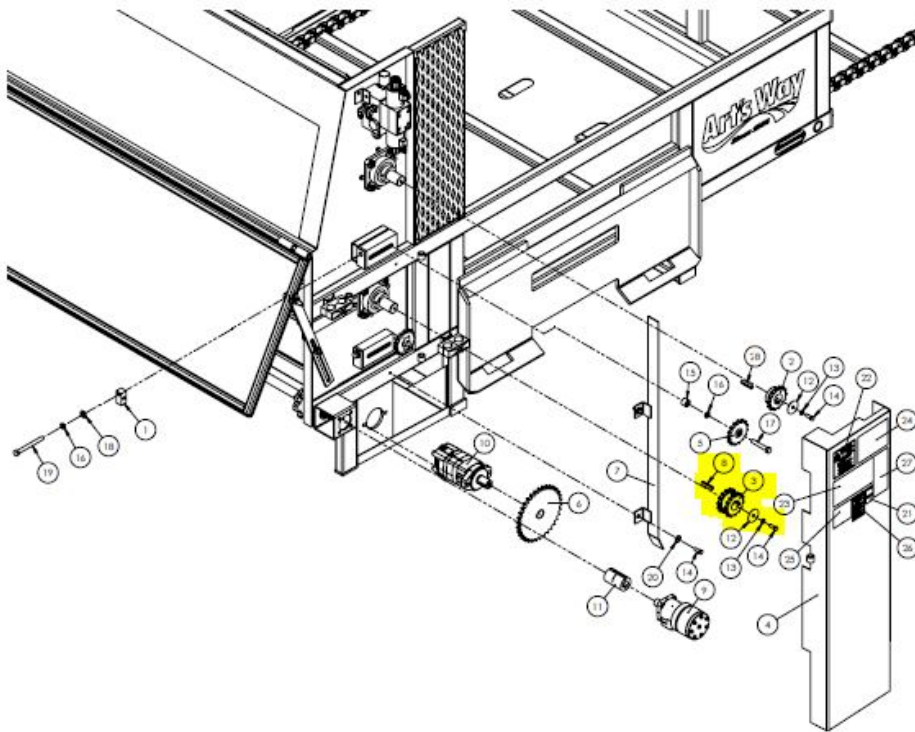
Diagram:

Parts Needed:

Part number 021530, quantity 1, is needed for this service bulletin.

ITEM NO.	PART NUMBER	DESCRIPTION	QTY.
1	650031	TENSION BOLT BLOCK	2
2	650130	60 X 14T 1.25 ID	1
3	650129	60 X 14T 1.25 ID	1
4	650142	DOOR WLDT	1
5	650131	15 TOOTH #60 IDLER	2
6	650132	60BS34 SPROCKET	1
7	650157	HOSE GUARD WLDT	1
8	021530	KEY, SQUARE 3/8 X 2	1
9	650101	HYDRAULIC MOTOR	1
10	650102	MOTOR, HYD.	1
11	MP40.00229	SHAFT COUPLER	1
12	650168	FENDER WASHER 2"	3
13	021180	WASHER, LOCK 3/8	2
14	012260	BOLT, HHCS 3/8-16 X 1	23
15	650300	3/4 SPACER	2
16	005370	WASHER, LOCK 1/2	4
17	990840	BOLT, HHCS 1/2-13 X 3"	2
18	005200	WASHER, FLAT 1/2 STD	8
19	650168	BOLT, HHCS 1/2-13 X 5	2
20	021190	WASHER, FLAT 3/8 STD	2
21	K18534203	DECAL, FEMA	1
22	467450	DECAL, WARNING MOVING PART	1
23	MP16.10552	DECAL, DANGER	1
24	MP16.20178	DECAL, WARNING	1
25	MP16.20181	DECAL, WARNING	1
26	MP21.09024	DECAL, WARNING	1
27	NH9611750	DECAL, WARNING	1
28	013510	KEY, SQUARE 3/8 X 1-1/4"	1
-	650127	UPPER ROLLER CHAIN (60H)	1
-	650126	LOWER ROLLER CHAIN (60H)	1

Time Allowed:

Art's Way estimates that this correction will take 1 hour of shop time.

2020 ART'S WAY MANUFACTURING COMPANY

5556 West Hwy. 9
Armstrong, IA 50514-0288
Tel: (712) 864-3131